

NO.	PART NAME	MATERIAL	NO.
1	BODY	DUCTILE IRON	1
2	DISC	CF8M	1
3	SEAT	EPDM/NBR/FKM	1
4	UPPER SHAFT	SS 431	1
5	LOWER SHAFT	SS 431	1
6	BUSHING	SS316+PTFE	4
7	PACKING PAD	PTFE	2
8	PACKING	NBR	1
9	O-RING	NBR	1
10	SCREW	SS304	4
11	LOCKING PAD	SS304	1
12	SCREW	SS304	4
13	END COVER	DUCTILE IRON	1
14	WASHER	SS304	4
15	SPRING WASHER	SS304	4
16	PLUG (14" ONLY)	A105 Zn Planting	1

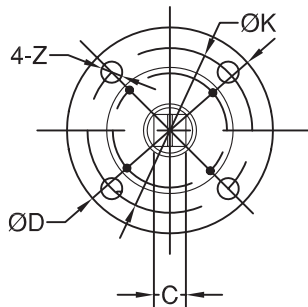

TOP FLANGE

DIMENSIONS (in)

SIZE	A	B	L	C	ISO 5211	ØD	ØK	H1	Z-4	ØJ	M	N	&°	H2
14	14.488	10.512	3.071	0.866	F12	5.096	4.921	1.378	0.551	18.752	12	1" - UNC-2B	30	0.551
16	15.748	12.165	4.016	1.063	F14	6.890	5.512	1.417	0.709	21.252	16	1" - UNC-2B	22.5	0.551
18	16.614	13.386	4.488	1.063	F14	6.890	5.512	1.417	0.709	22.752	16	1-1/8" - 11UNC-2B	22.5	0.551
20	17.913	14.370	5.000	1.417	F16	8.268	6.496	1.417	0.866	25.000	20	1-1/8" - 11UNC-2B	18	0.591
24	22.244	17.795	6.063	1.417	F16	8.268	6.496	1.811	0.866	29.500	20	1-1/4" - 10UNC-2B	18	0.591

DESCRIPTION:

Dim Dwg (inches) - 14"-24" API 609 -
150# Lug Body Bare Shaft Resilient Seated BFFV

DATE:

04.29.24

DWG:

TS-DD0003-A



McWane Plant & Industrial
1201 Vanderbilt Road
Birmingham, AL 35234